



(Shown with pendant mount. See how to order for mounting options)

DESIGNED FOR USE IN EXPLOSION-PROOF ATMOSPHERES

- Approved for mounting in any manner-including dome up
- Available in 24VDC and 120VAC
- Six lens colors
- 10,000 hour strobe tube
- ¾" NPT pendant, ceiling and wall mount options available
- Dome guard optional
- Type 4X, IP66 enclosure
- Marine Rated
- UL and cUL Listed and CSFM Approved

Explosion-Proof Strobe Light

Model 27XST

Federal Signal's Model 27XST explosion-proof strobe light produces 80 high-intensity flashes per minute. This warning light operates on 24VDC and 120VAC, 50/60Hz and is unique to the market because it covers an entire range of possible mounting configurations – including dome up.

The 27XST is UL Listed for Class I, Division 1, Groups C and D; Class II, Division 1, Groups E, F and G; Class I, Division 2, Groups A, B; and Class III. The 27XST is UL and cUL listed, and Marine Rated.

The 24VDC 27XST features a voltage in-rush limiting PCB design that provides greater compatibility with factory automation control systems and less electrical interference with in-rush sensitive devices.

The 27XST is Type 4X rated; constructed to IP66. Corrosion resistance is achieved with a powder coat finish applied over the copper-free aluminum housing.

Federal Signal's Model 27XST has an effective candela (ECP) of 850 and a two million peak candela. The 27XST can be paired with a pendant, ceiling or wall mount. For easy installation, the mounting box is first installed and the fixture is then threaded onto the mounting box, making the electrical connection. Electrical continuity is made when five threads are engaged.

Federal Signal's Model 27XST is specifically designed for explosion-proof atmospheres and/or corrosive environments. Because it is easy to install and requires very low maintenance, it is ideal for use in areas such as oil rigs, mines, refineries, and chemical plants.

Hazardous Location Rating:

T-Code at Maximum Ambient Temperature, °C		
Hazardous Location	40°C	65°C
Class I, Div 1 & 2, Groups C & D	T6/85°	T4A/120°
Class I, Div 2, Groups A & B	T2/300°	T2/300°
Class II, Div 1, Groups E, F & G	T6/85°	T4A/120°
Class III	T6/85°	T4A/120°

Model	Voltage	Operating Current	Flash Rate/Minute	Candela Peak ²	ECP ³
27XST-024_*-MOD ¹	24VDC	1.90 amps (3.0 amp In-rush)	80	2,000,000	850
27XST-120_*-MOD ¹	120VAC 50/60Hz	1.14 amps	80	2,000,000	850

* Indicates color: (A) Amber, (B) Blue, (C) Clear, (G) Green or (R) Red (Magenta available in 120VAC model only)

¹ See "how to order" for mounting options.

² Peak candela is the maximum light intensity generated by a flashing light during its light pulse

³ ECP (Effective Candela) is the intensity that would appear to an observer if the light were burning steadily



EXPLOSION-PROOF STROBE LIGHT (27XST)

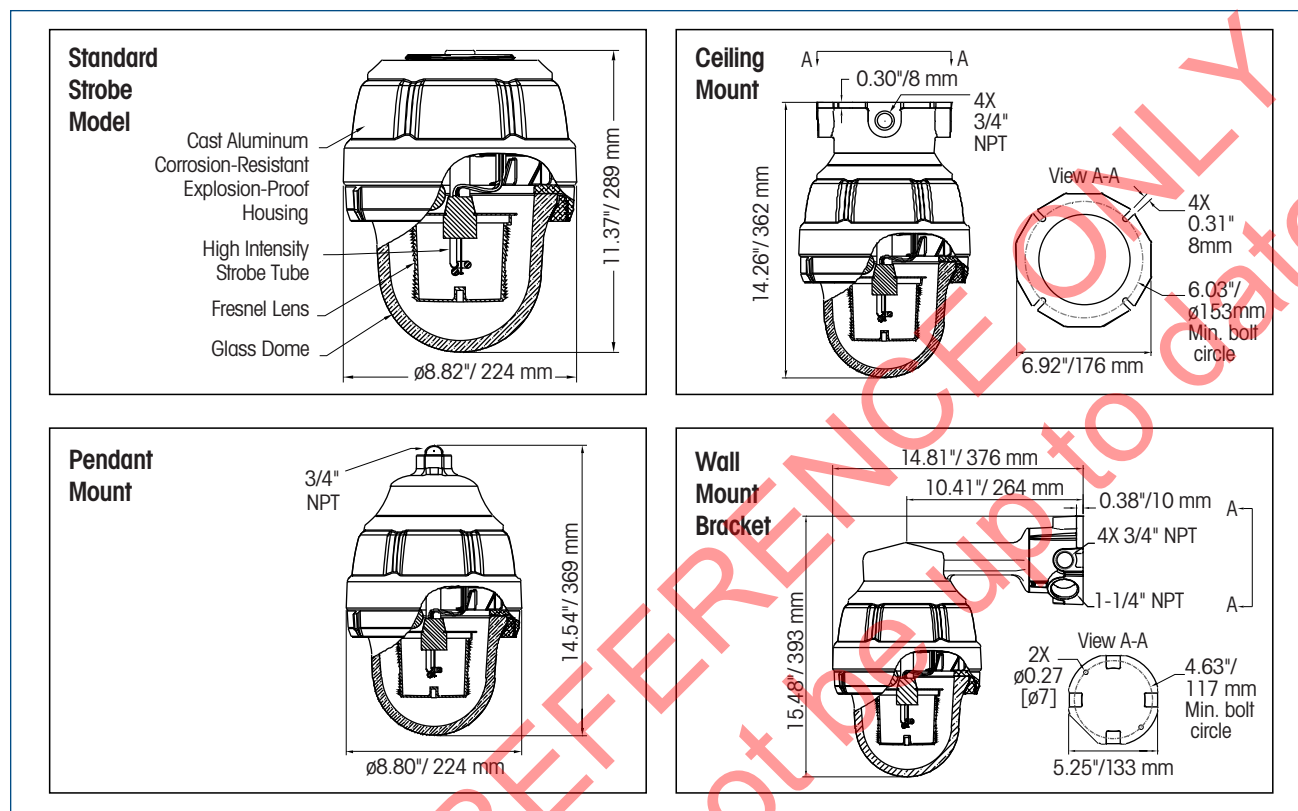

SPECIFICATIONS

Lamp Life:	10,000 Hours	10,000 Hours
Light Source:	Strobe tube	Strobe tube
Operating Temperature Range	-67°F to 150°F	-55°C to 65°C
Net Product Weight		
Signal without Mounting:	13.9 lbs	6.3 kg
Ceiling Mount:	4.5 lbs	2.0 kg
Pendant Mount:	2.0 lbs	0.9 kg
Wall Mount:	5.9 lbs	2.7 kg

HOW TO ORDER

Light and Mounting Kit must be ordered together.

1. Specify model, voltage and color
2. Specify Mounting Kit

Ceiling Mount (CMXC-SB)
Pendant Mount (PMXC-SB)
Wall Mount (WMXC-SB)

- Optional Accessories:
Dome Guard (DGXC-SB)

REPLACEMENT PARTS

<u>Description</u>	<u>Part Number</u>	<u>Description</u>	<u>Part Number</u>
Exterior Dome Assembly, Clear	K8436147A	24VDC Mechanism	K8436107F-03
Interior Lens Assembly, Amber	K8550C095A-02	120VAC Mechanism	K8436107E-02
Interior Lens Assembly, Blue	K8550C095A-01	Strobe Tube	K8107159A
Interior Lens Assembly, Clear	K8550C095A	PC Assembly, 24VDC	K2001918B-01
Interior Lens Assembly, Green	K8550C095A-04		
Interior Lens Assembly, Magenta	K8550C095A-07		
Interior Lens Assembly, Red	K8550C095A-03		