

# SelecTone® Connector Kits

Models AM25CK and AM70CK

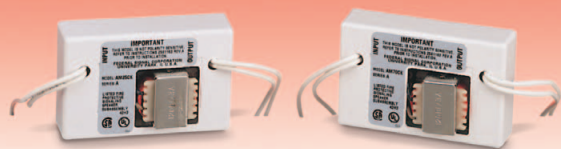

## EXPANDS PUBLIC ADDRESS SYSTEM CAPACITY

- Interfaces SelecTone® speaker/amplifiers with an existing paging system
- Works in 25 or 70 Vrms systems
- Creates a “balanced line” SelecTone® System
- UL and cUL Listed, CSA Certified and CSFM Approved

The Models AM25CK and AM70CK are connector kits which allow the use of SelecTone® speaker/amplifiers (1 Vrms devices) to be used in any public address system (25 or 70 Vrms).

Using these connectors and the 25 Vrms output from the 300VSC-1, 300VSC-1044SB, 300SCW-1 or 300MB SelecTone Command Center creates a true “balanced line” system which will filter all extraneous noise from the audio lines.

Expanding a centrally amplified public address system often requires the addition of another control amplifier. With the appropriate connector kits and SelecTone speaker/amplifiers, the system can easily be expanded, without the costly addition of a central amplifier.

Public address equipment manufacturers do not offer a wide selection of explosion-proof products. Now adding a Class I, Division 1, or Class I, Division 2 device to an existing central PA system is simple; select either a 300X, 300GCX, or 302GCX speaker/amplifier and the appropriate connector kit.

SelecTone typically require a minimum of 18-gauge twisted pair, isolated from the AC line. With an AM series connector kit and the 25 Vrms output of the SelecTone control, a balanced line is created which filters induced line noise. This also allows the installer to use smaller gauge wire without the risk of poor intelligibility.

Federal Signal’s SelecTone Connector Kits allow existing public address systems to be expanded with SelecTone speaker/amplifiers — no additional central amplifier is required.



## SELECTONE® CONNECTOR KITS (AM25CK/AM70CK)

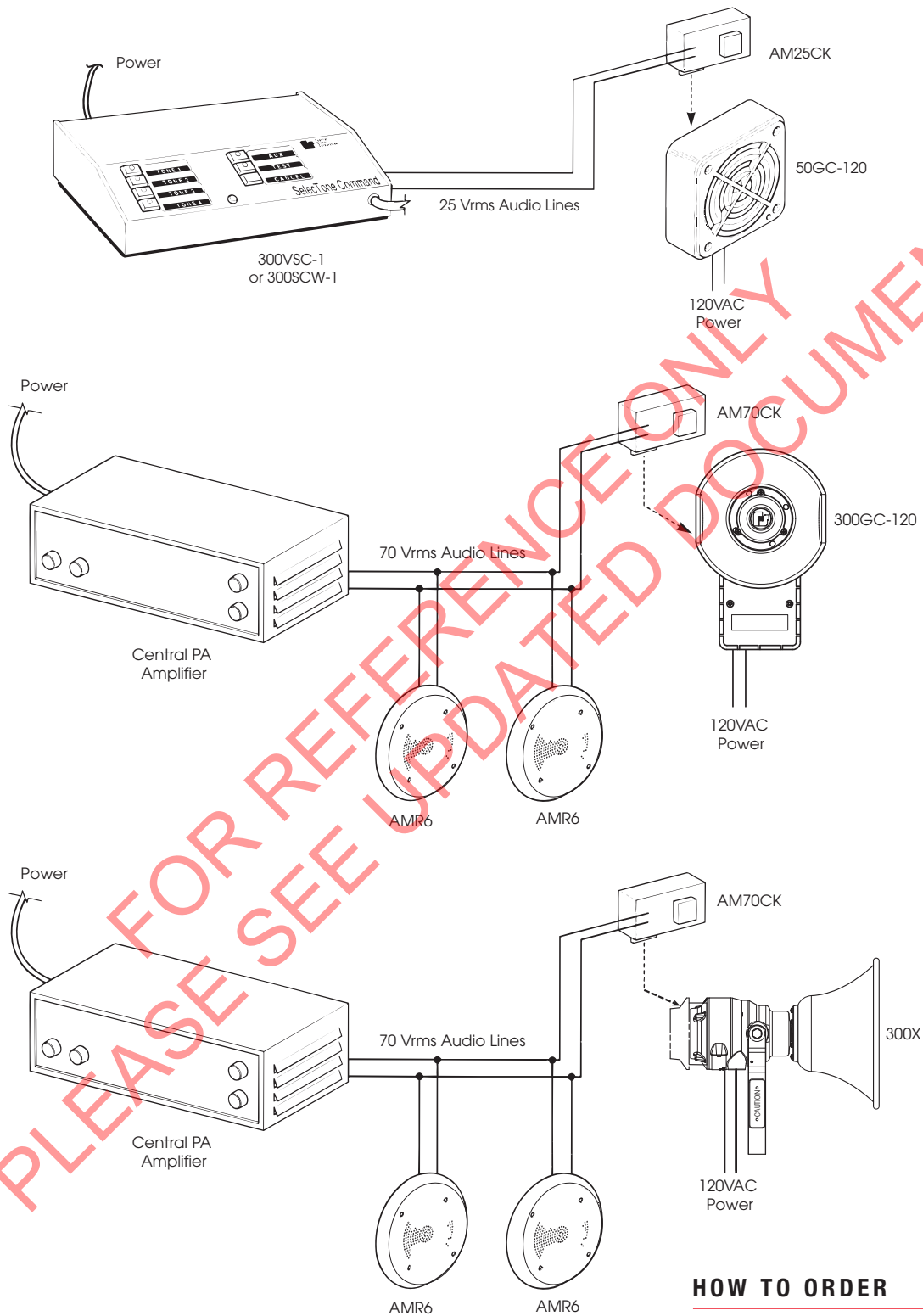

### HOW TO ORDER

- Please refer to Model Number Index AM25CK/AM70CK beginning on page 375